

# Operation Guide 5458

- Your watch may differ somewhat from the one shown in the illustration.

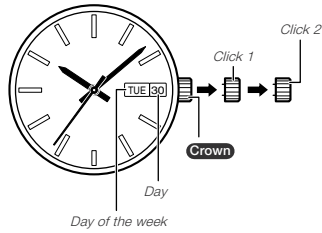

**Crown Operations**

Some water-resistant models (100 meters, 200 meters) have a screw-in crown. When you need to perform a crown operation, rotate it towards you to unscrew it. Then pull the crown out. Avoid applying undue force when pulling. The watch loses its water resistance while the crown is unscrewed. After performing a crown operation, fully screw the crown back in.

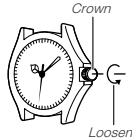

**If your watch has a rotary bezel...**

You can rotate the bezel to align its ▼ mark with the minute hand. Then you will be able to tell how much time has elapsed since aligning the ▼ mark.

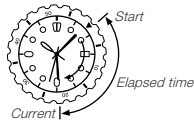

**Specifications**

- Accuracy:** ±20 seconds average per month
- Battery:** One silver oxide battery (Type: SR621SW)
- Battery Life:** Approximately 3 years

**To adjust the time setting**

When the second hand is at 12 o'clock, pull the **Crown** out to Click 2.

Rotate the **Crown** to change the time setting.

Push the **Crown** back in.

**Note**

- Take care that you set the correct AM or PM time.
- When changing the time, move the minute hand four or five minutes past your final setting, and then back it up to the setting you want.

**To change the day and day of the week settings**

Pull the **Crown** out to Click 1.

Rotate the **Crown** towards you to set the day.

Rotate the **Crown** away from you to set the day of the week.

Push the **Crown** back in.

**Note**

- The day setting uses a 31-day month. Make adjustments for months of shorter lengths.
- Avoid changing the day and day of the week settings between the hours of 9 p.m. and 4 a.m. Otherwise, the day and day of the week may not change correctly at midnight.